

3 BHK
LUXURY FLOORS

SECTOR-2, SOUTH OF GURUGRAM

SOHNA

WHERE
NATURE *meets* SERENITY

A peaceful retreat nestled at the foothills of the Aravallis, blending scenic beauty with modern living.

A man in a white shirt is seen from the back, looking at a detailed architectural model of a city. The model features various skyscrapers, residential buildings, and green spaces. The scene is set in a high-rise office with large windows overlooking a cityscape. The lighting is warm, suggesting sunset or sunrise. A large, semi-transparent 'S' shape is overlaid on the right side of the image.

Sohna

A Growing Hub of Modern Living



Smart Investment



Seamless Connectivity



Rapid Development



A LIFESTYLE OF
LUXURY

3BHK LUXURY FLOORS

THOUGHTFULLY CURATED, SEAMLESSLY DELIVERED



COMMUNITY
HALL
(PROVIDED BY COLONISER)



LANDSCAPED
PARK
(PROVIDED BY COLONISER)



BASKETBALL
COURT





CCTV
SURVEILLANCE
(BUILDING PREMISES COVERAGE ONLY)



POWER
BACKUP



HIGH-SPEED
LIFT



24*7
SECURITY
(PROVIDED BY COLONISER)



SECURED
PARKING

Essence

of Tranquility, Inspired by Nature



Peaceful Living



Premium Amenities



Balanced Lifestyle

SITE MAP



DISCLAIMER: THIS IS NOT A SALES BROCHURE OR ANY TYPE OF MARKETING MATERIAL. REPRESENTATIVE IMAGE ONLY. THE ACTUAL PRODUCT/DEVELOPMENT OF THE PROPERTY SHALL DIFFER FROM THE IMAGE SHOWN ABOVE.

STILT FLOOR PLAN

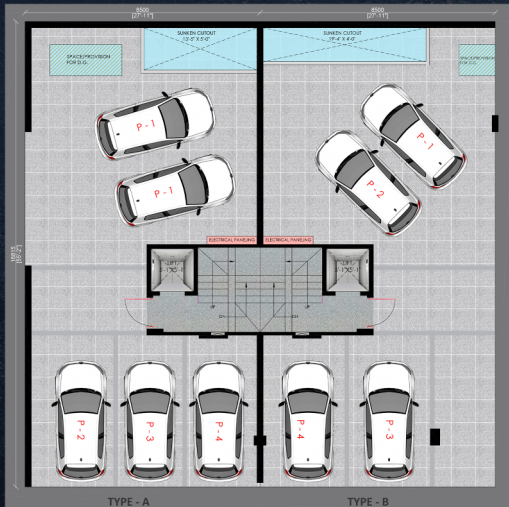

BASEMENT FLOOR PLAN

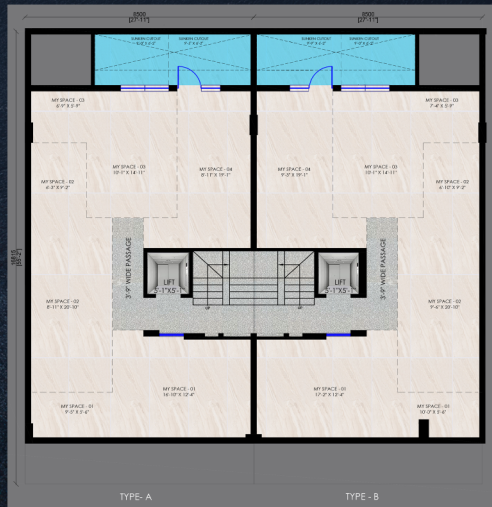

DISCLAIMER: THIS IS NOT A SALES BROCHURE OR ANY TYPE OF MARKETING MATERIAL REPRESENTATIVE IMAGE ONLY. THE ACTUAL PRODUCT/DEVELOPMENT OF THE PROPERTY SHALL DIFFER FROM THE IMAGE SHOWN ABOVE.

“CRAFTED FOR DISTINCTION”