



HARERA Reg. No. : RC/REP/HARERA/GGM/  
927/659/2025/30 Date: 25.03.2025  
www.haryanarera.gov.in



# VEDATAM

VALUES INBUILT

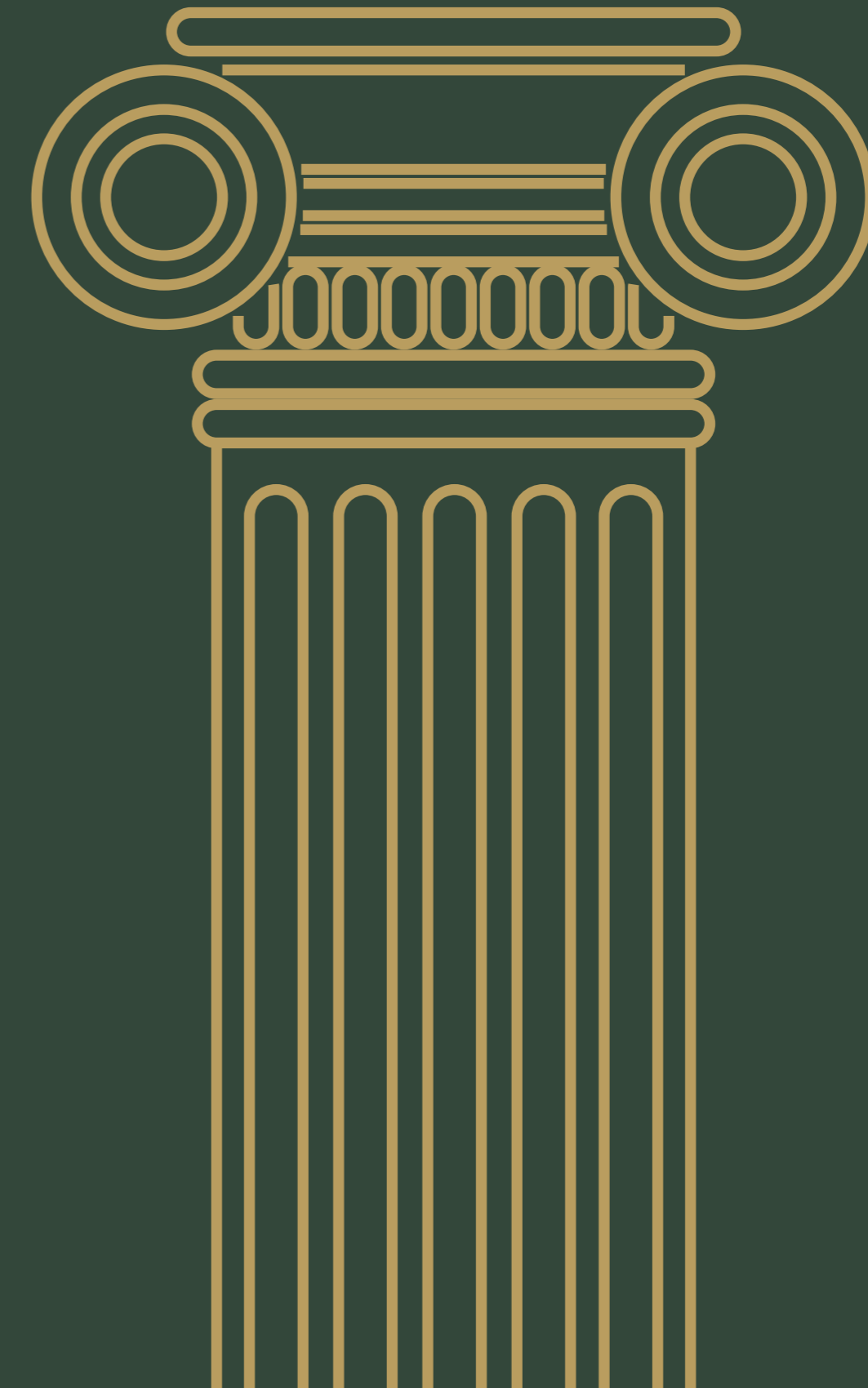

SPJ Properties Pvt. Ltd.  
Registered office: UGF - 6, Antriksh Bhawan, KG Marg, New Delhi - 110001  
Site office: Vedatam, Sector - 14, Gurugram, Haryana - 122001  
Email: info@spj-group.com | Phone: +91 90552 90552  
CIN - U70109DL2021PTC391005

Disclaimer: The information available in this advertisement is subject to change without any notice. While every effort has been made to provide the details, particulars, contents and other graphics appearances in this advertisement as updated, correct, complete and accurate, nevertheless, inadvertent errors may occur in the information. Further, our website(s) and other advertising and publicity material include artist's impressions indicating the anticipated impressions of the appearance of completed development and do not constitute an offer, an invitation to offer and/or commitment of any nature between us and the recipient.

The  
city has a  
heart  
and it's  
pulsing with  
new  
energy.

A place

where

it all began,

a place

that

continues

to inspire.

Today

it's all

set to

rewrite

the future.

P R E S E N T I N G



**VEDATAM**  
VALUES INBUILT

The first  
organised  
retail hub  
right at the  
heart of  
Gurugram.

SECTOR  
**14**

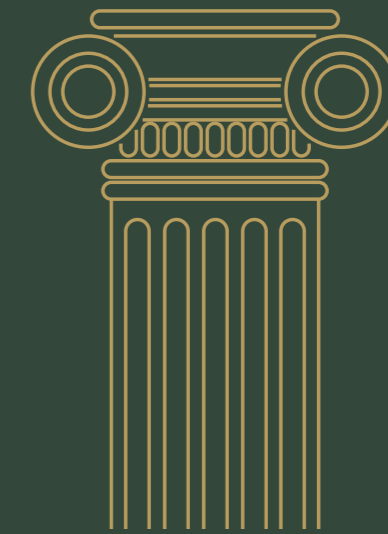

Not only is Vedatam a first, it's a destination that puts the spotlight on Sector 14, Old Gurugram, all over again.

Vedatam offers an exclusive blend of:

- \* Premium retail spaces
- \* Fine dining
- \* Food court
- \* Multiplex
- \* Entertainment zone
- \* Club & lounge

With world-class infrastructure and unparalleled amenities, the project is spread across 4.15 acres and brings everything together under one roof.

NO FORECAST,  
ONLY FOOTFALL.

SPJ | VEDATAM  
TRUE REALTY | VALUES INBUILT

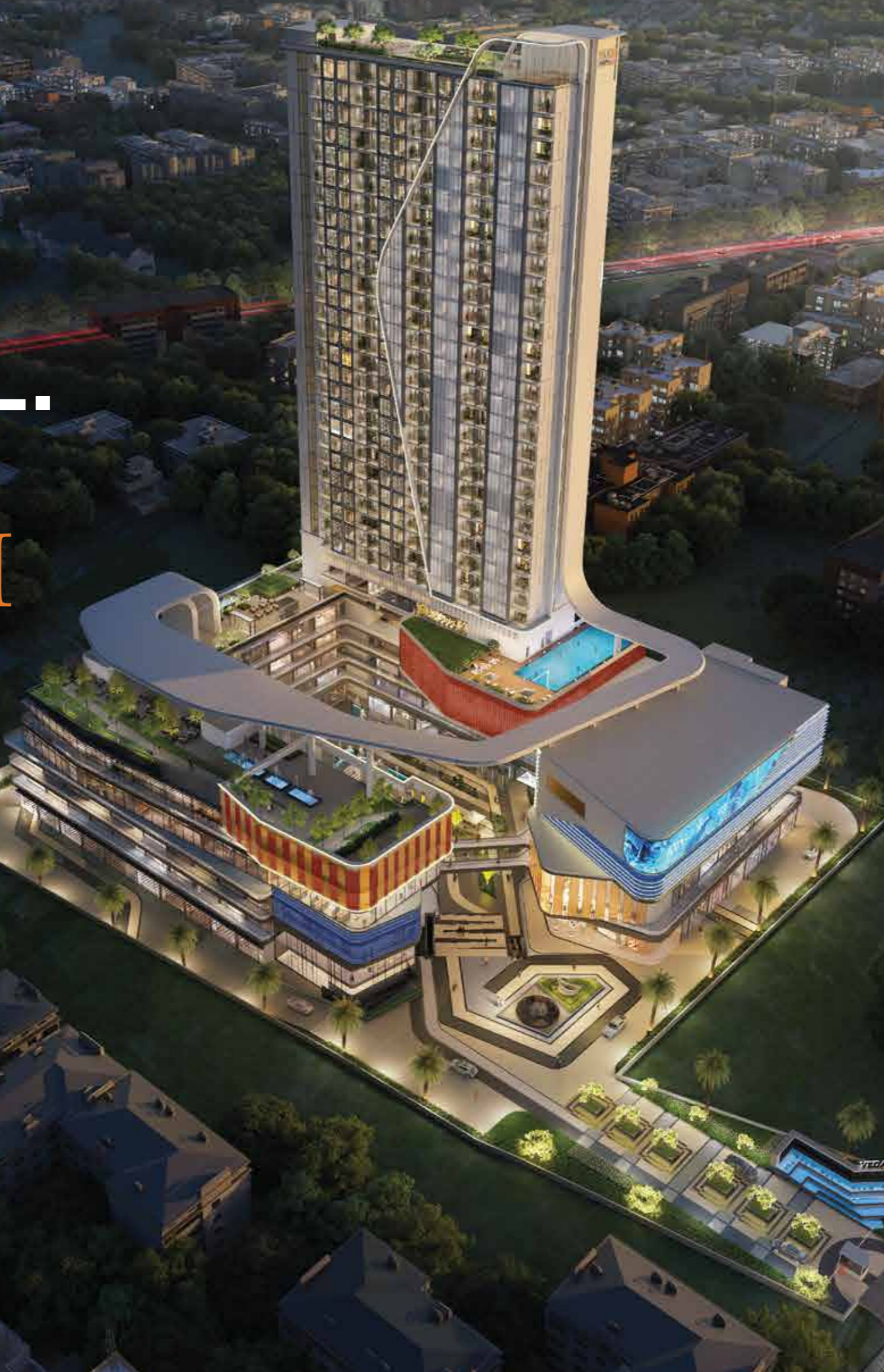

A thriving residential and commercial hub, Sector 14 has long been at the heart of Gurugram's urban landscape.

With its prime location and well-planned infrastructure, it has always been a preferred choice for families and businesses alike.

# Nourishing the roots of Gurugram at Sector 14 with renewed energy.

With a high urban population density, Sector 14 promises affluent catchment and renewed business opportunities. Today, Sector 14 stands as the root of development. The next great chapter in its history is about nurturing the future. A future built on a strong foundation, propelled by momentum, and poised for an enduring legacy.

# SPJ VEDATAM



SECTOR 14



MAP NOT TO SCALE

-  RESIDENTIAL
-  HOTEL
-  HOSPITAL
-  AIRPORT
-  SHOPPING
-  TENTATIVE METRO LINE



SCAN TO NAVIGATE

<b>URBAN POPULATION:</b>	3,200,000 (approx.)
<b>COMMERCIAL PARKS:</b>	DLF Phase III: 8.6 km Cyber City: 2 - 3 km IFFCO Chowk & HUDA City Centre: 4-6 km Mehrauli-Gurgaon Road: >1 km
<b>RESIDENTIAL CATCHMENT AREAS:</b>	Sector 15 (1 & 2): 1-2 km Sector 17 & 18: 2 -3 km Sector 22 & 23: 5 km Palam Vihar: 6 km Sushant Lok: 8 km
<b>CONNECTIVITY:</b>	Airport: 10 km Dwarka Expressway: 5 km
<b>SCHOOLS:</b>	The English School: 0.3 km Sunrise Public School: 0.45 km
<b>HOSPITALS:</b>	Saraswati Hospital: 0.31 km Medanta-The Medicity: 5 km

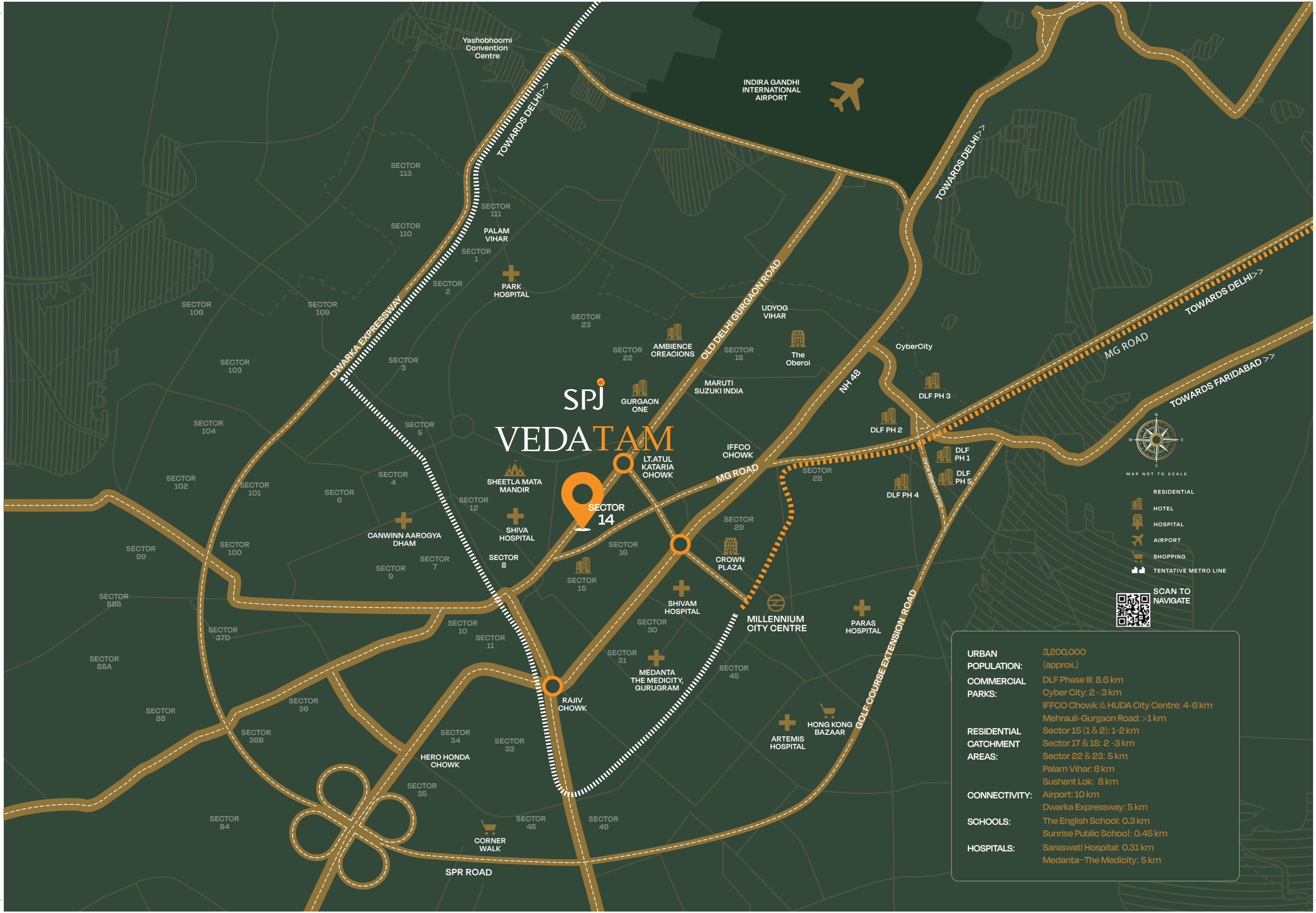

Enter an era of  
new beginnings.



Urban retail  
excellence  
across  
three levels.  
Destined to  
win over  
hearts.



Vedatam delivers a world-class retail experience across three meticulously designed levels - lower ground floor, upper ground floor, and first floor. This multi-tiered layout enhances visibility and accessibility, creating an ideal showcase for brands and an effortless shopping experience for visitors.

**Retail area overview:**

**Lower Ground Floor:** 8450 sq. mt. approx.

**Upper Ground Floor:** 9430 sq. mt. approx.

**First Floor:** 9000 sq. mt. approx.



The new face of Gurugram.



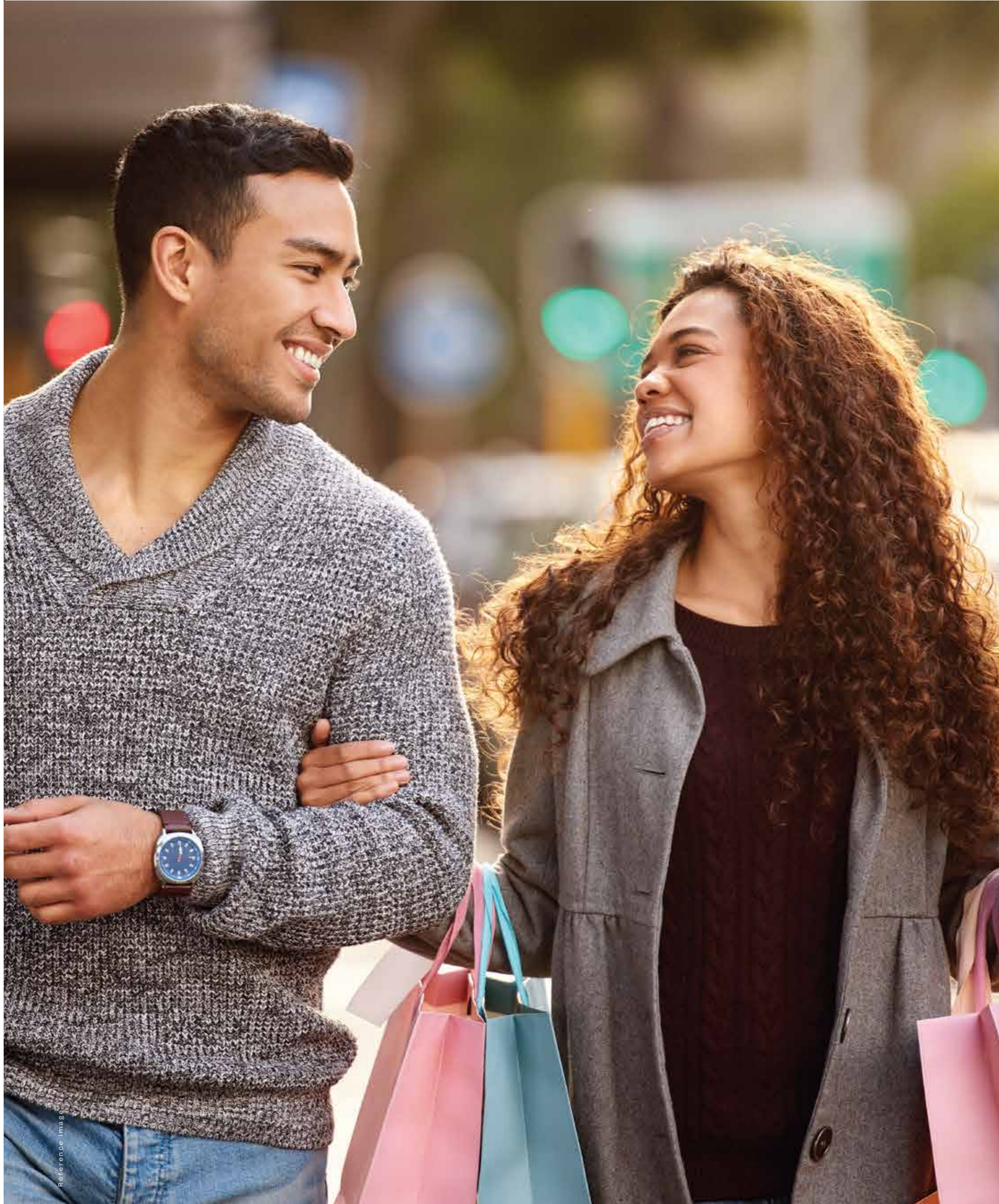

KANAKA : Lower / Upper / First Floor

Retail  
therapy  
for  
connoisseurs.

Discover a world of style and sophistication at Vedatam's lower ground, upper ground, and first floor.

A gateway to timeless and exceptional shopping experience.

The curated selection of premium brands at Vedatam cater to every indulgence.

Here it isn't just about what one buys; it's about how it makes one feel.

RAASA: Second Floor

Where  
stories unfold  
through  
cuisines.



Artistic Impression



Reference Image

A dedicated culinary destination on the second floor, featuring fine dining options, diverse outlets, and a spacious food court. Its vibrant ambience ensures every visit is a delightful and unforgettable experience.

Second floor area:  
8750 sq. mt. approx.

A premier dining destination that caters to every taste:



Quick  
bites



Multi-cuisine  
family restaurants



Gourmet  
restaurants



Reference image

## TARANG: Third Floor

# Endless entertainment, unlimited excitement.

Tarang, Vedatam's third floor is set to become the city's premier entertainment destination.

The multiplex offers a world-class cinematic experience with plush seating, stunning visuals and immersive audio experiences.

Complemented with upscale dining and entertainment options, this level promises an all-encompassing experience across age groups.

Third floor area:  
8230 sq.mt. approx.

Featuring:

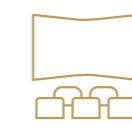

Luxurious  
multiplex



Interactive  
entertainment spaces



Pub  
& Lounges

A spectacular hub  
in the heart of Gurugram.



# Exceptional features. Extraordinary amenities.

Vedatam redefines commercial excellence with an array of world-class amenities, designed to enhance convenience, safety, and operational efficiency.

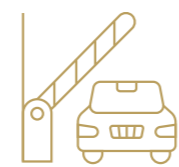

Up to 1100 car parking spaces with seamless ingress and egress



High speed elevators and escalators



Complete CCTV monitoring



100% power back up



Earthquake resistant structure



Uninterrupted water supply



Sprawling food court with national & international QSR brands



Exclusive fine dining restaurants for families



Dedicated family entertainment zone



One-stop shop for major fast fashion & lifestyle brands



Ample open spaces with Central Courtyard



Superior fire safety measures



Changing/feeding room for babies

Here  
customers  
feel special.  
So do their  
cars.

Vedatam sets a new benchmark in visitor convenience with its expansive car parking facility, with a capacity to accommodate upto 1100 vehicles.

**KEY**

**HIGHLIGHTS :**



Over 1,100  
car parking  
spaces



Seamless accessibility  
for goods and people,  
enhancing convenience



Three-level car parking:  
the only one of its kind  
in the vicinity



Advanced  
security measures  
for optimised safety



Generous 14 ft.  
basement height  
for easy movement



# Master Layout

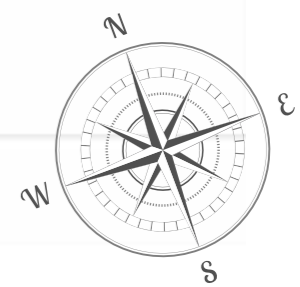
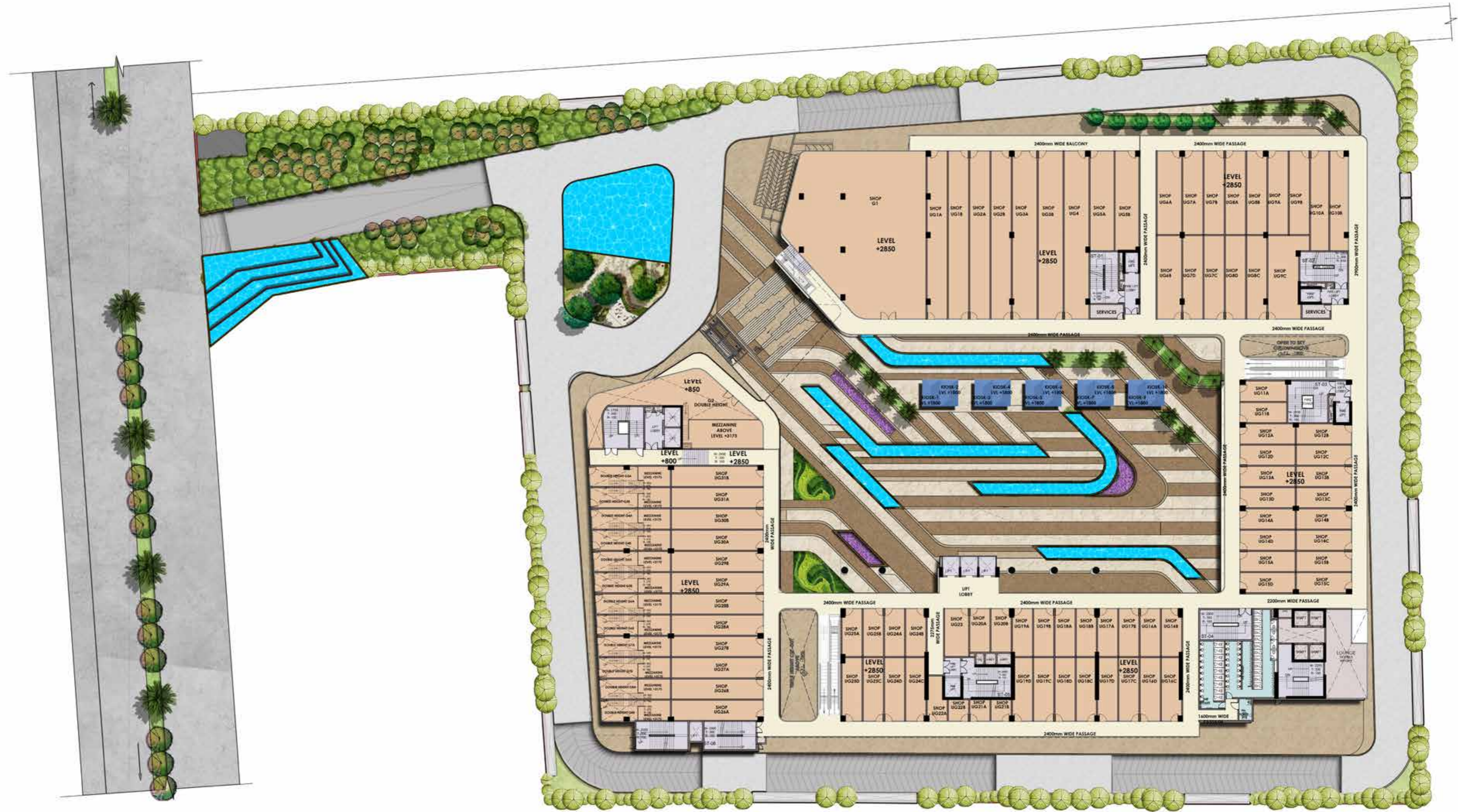

It's all about  
connecting seamlessly.



The  
craftsmen  
who build  
legacies.

**ACPL**<sup>®</sup>  
INDIA • DUBA

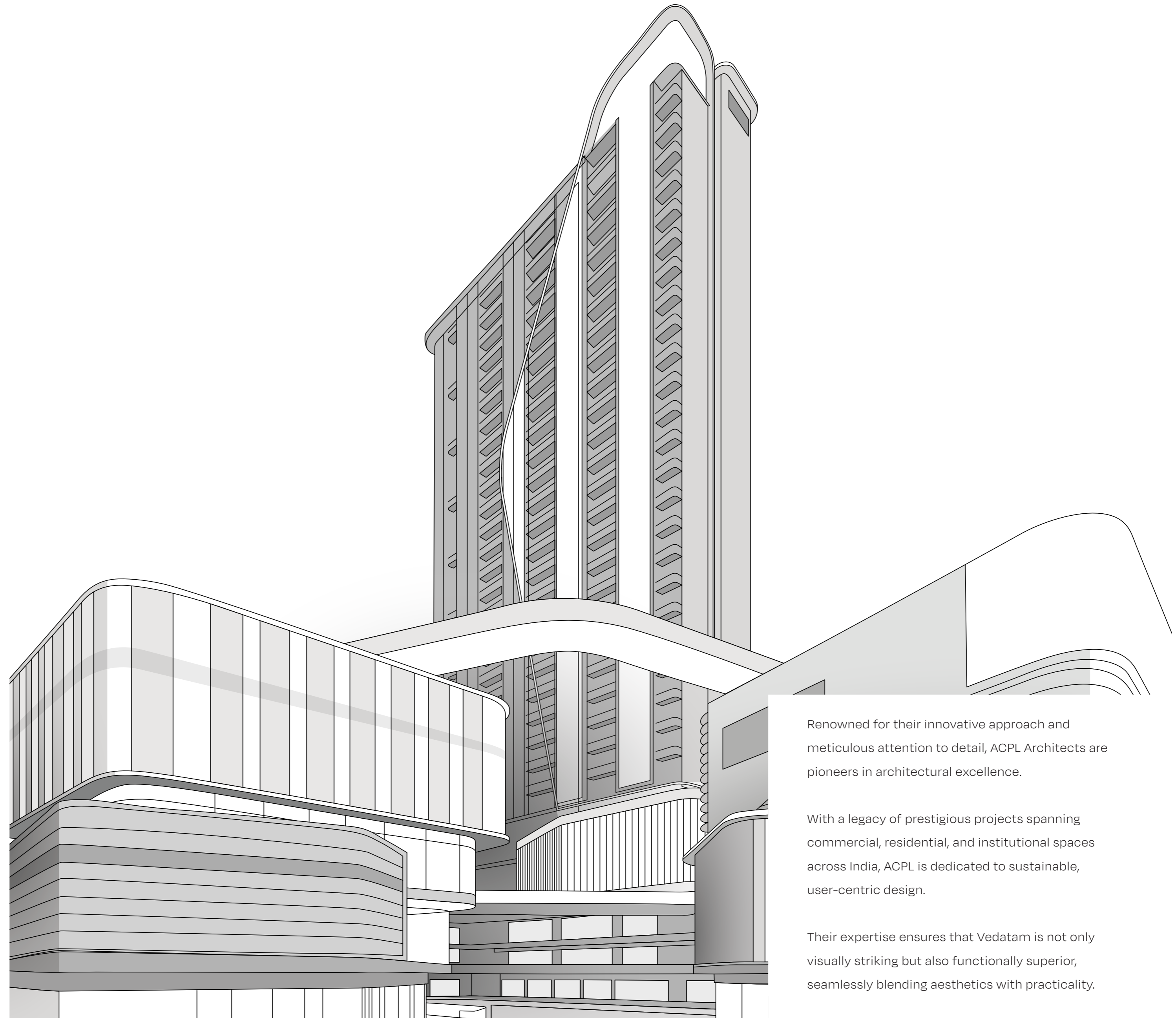

Renowned for their innovative approach and meticulous attention to detail, ACPL Architects are pioneers in architectural excellence.

With a legacy of prestigious projects spanning commercial, residential, and institutional spaces across India, ACPL is dedicated to sustainable, user-centric design.

Their expertise ensures that Vedatam is not only visually striking but also functionally superior, seamlessly blending aesthetics with practicality.

Urban  
excellence, redefined.





OUR STORY

# A JOURNEY OF EXCELLENCE, A LEGACY OF DISTINCTION.

A legacy spanning 30+ years, SPJ Group is a business conglomerate serving communities, with customer centricity, integrity, sustainability and an uncompromised commitment to quality at its core. Our legacy delivers premium residential and commercial developments rooted in meticulous craftsmanship and innovation. We create spaces that seamlessly blend luxury and functionality, nurturing joy in homes, businesses and learning environments. Beyond real estate, our versatile portfolio spans hospitality, education, agriculture and financial services. With in-depth financial engineering, the company withholds a vision to touch lives of countless individuals upgrading lifestyle in various ways.



Reference image

# A testament to excellence.



From visionary real estate developments to transformative ventures in hospitality, agriculture, finance, and education, SPJ Group stands as a beacon of progress and innovation.

#### ● **SPJ REAL ESTATE**

Our real estate ventures are dedicated to quality and finesse, enriching the Northern regions of India, Tricity, Himachal Pradesh and Delhi NCR with residential and commercial developments like The Orion and Jain Farms.

#### ● **SPJ HOSPITALITY**

Our landmark projects in hospitality such as Ramada Ajmer has set new standards in hospitality. Our upcoming project in Sonmarg is all set to redefine leisure.

#### ● **SPJ AGRICULTURE**

With a commitment to sustainability, our eco-conscious agriculture initiatives such as the Poly House Sustainable Farming Oasis in Alwar, help us reconnect with the nature.

#### ● **SPJ EDUCATION**

At SPJ, we have undertaken ventures that have ignited a passion for space exploration with the masses such as Space Global and Astroport.

#### ● **SPJ FINANCE**

At SPJ, we specialise in providing tailored financial solutions designed to cater diverse investment goals, revive distressed units, provide venture capital and also facilitate leasing solutions.

Led by industry stalwarts, our journey is driven by passion, integrity, and the pursuit of innovation. As we continue to expand, SPJ remains steadfast in building a future that is responsible and impactful – one that honours our heritage while embracing boundless possibilities.

